

### 3 Considerations When Powering Your Pedals:

**1. Voltage (V):** This is the amount of power that the pedal requires. If it needs 9Vdc, always plug it into a 9Vdc output. Don't plug it into a 12 or 18Vdc output unless you are sure that it can handle the extra voltage, and you have checked with the pedal manufacturer.

**2. Polarity (-/+):** All DC powered pedals will indicate polarity near the DC jack. There can be negative tip or positive tip. All 1 SPOT Pro outputs have a negative tip polarity, (except for output #12 on the back of the CS11 and the inputs on XP5 and XP8). However, if your pedal needs a positive tip polarity you can use a CYR converter plug (not included) on the pedal to reverse the tip polarity from negative to positive

This symbol shows "negative tip" polarity, for example: +  -

**3. Current (mA):** Each pedal requires a specific amount of current that is measured in milliamps (mA). **When it comes to current (mA), the pedal will only draw what it needs** to function properly, and it is best to have more mA available than the pedal needs. One of the great features of the 1 SPOT Pro is that each output can provide more current (mA) than it indicates on the enclosure. Please note: most pedal manufactures do not indicate the actual mA draw of their products. Instead, they will generally match the mA specs on the pedal to the power supply that they make. If you want to know how many mA your pedal is actually drawing, check out our mA Meter at [Truetone.com](http://Truetone.com)

#### Things to remember about current draw (mA)

1. You always want to have more available than you need.
2. A pedal will only draw the amount of current (mA) that it needs to function properly.
3. If an output on the 1 SPOT Pro does not have enough current available to power the pedal, and you have properly matched the voltage and polarity, the pedal simply won't power up or function properly. You won't damage either the pedal or power supply.

Save Energy! Unplug your 1 Spot Pro when not in use.  
Like with any electrical device, this will also prolong the life of your gear.



[Truetone.com](http://Truetone.com)



*XP5 and XP5-PS  
pure isolated power*

*Owners Manual*



[Truetone.com](http://Truetone.com)

## IMPORTANT SAFETY INSTRUCTIONS

1. All the safety and operating instructions should be read before this product is operated. Keep these instructions for future reference.
2. Pay attention to all warnings on the power supply and in the operating instructions.
3. **WARNING:** Do not use this device near water or any other liquid.
4. Clean only with dry cloth.
5. Do not block any ventilation openings.
6. Do not use this device near any heat sources.
7. Do not remove the power plug grounding pin on IEC input cables.
8. Protect all input and output power cables from being walked on or pinched.
9. Only use attachments/accessories specified by the manufacturer.
10. Use only with the brackets and screws provided with this power supply.
11. Unplug this device during lightning storms or when unused for long periods of time.
12. Refer all repairs to qualified personnel at Truetone or an authorized Truetone distributor. Under no circumstances should the power supply be opened by the user.
13. This lightning flash with arrowhead symbol within an equilateral triangle is intended to alert the user to the presence of non-insulated "dangerous voltage" within the product's enclosure that may be of sufficient magnitude to constitute a risk of electric shock.



- **WARNING:** To reduce the risk of electric shock, do not remove cover (or back) as there are no user-serviceable parts inside. Refer servicing to qualified personnel.

- The exclamation point within an equilateral triangle is intended to alert the user to the presence of important operating and maintenance instructions in the literature accompanying the appliance.

14. The maximum ambient temperature should not exceed 35 degree C.
15. Date code: YYMM, YY means year, MM means month. For example: 2312 represents Year 2023, December.

### Connecting an XP5 to a CS11:

Your XP5 can be powered directly from a Truetone CS11, as shown below, to give you 5 extra isolated outputs. In fact, you can even connect a second XP5 to the first, to give you 10 extra outputs. The only thing you should check if you're using two XP5's is that the total current of all pedals connected to the XP5's is 2500mA or less. Suggestion: Use a Truetone mA Meter (sold separately) to check for total current.



Congratulations on your purchase of the 1 SPOT Pro XP5 by Truetone! The 1 SPOT Pro XP5 provides 5 outputs to power just about any effect pedal. All 5 outputs are completely isolated, regulated, and filtered to provide quiet and safe operation for your valuable effects pedals.

**The 1 SPOT Pro XP5 (or XP5-PS) includes the following cables:**

Power cables (all DC cables are center pin negative polarity, 5.5x2.1mm):

- (3) DC18 (18" or 457mm) – White
- (2) DC12 (12" or 305mm) – Yellow
- (1) DCLINK (XP5 only) – 20" input cable for connection to CS11 or linking 2 XP5 units.

**Power Adapter Specifications (XP5-PS only):**

**Input:** 100-240Vac, 50/60Hz, 0.8A (Worldwide input voltage)

**Output:** 12.0Vdc, 2.5A 30W

**Interchangeable Plugs:** The XP5 power adapter comes with 4 different plugs which allow you to use it almost anywhere in the world. To change the plug:

1. Push and hold the tab next to the plug while turning counterclockwise.
2. Remove the plug.
3. Install the desired plug by inserting it at a slight angle.
4. Turn clockwise until you hear it click into place.

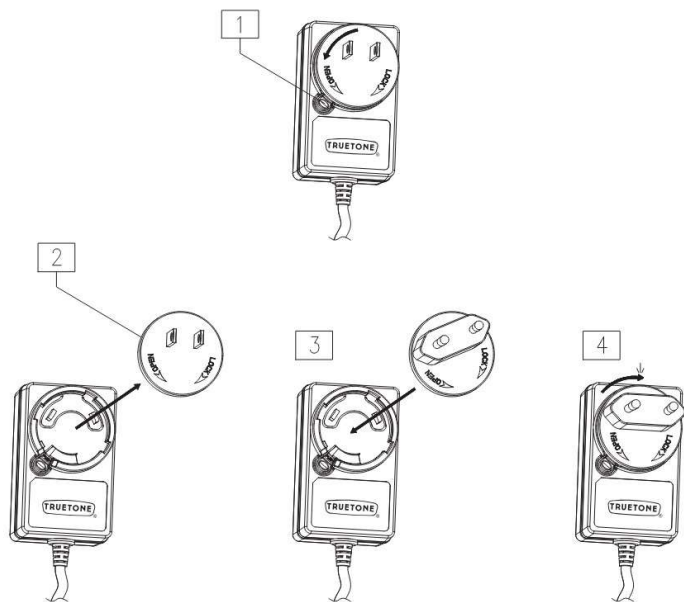

Please Note: Each output on a 1 SPOT Pro can actually handle more than the stated mA number. The most important thing to know is the total mA current draw of all your pedals combined. Most likely, you will not exceed the total of all the output labels, which is 2500mA. If you don't know the mA draw of each of your pedals, please consider purchasing the Truetone mA Meter, sold separately.

The bottom of the XP5 is clearly labeled to show the input and output specs. Please note that **you can apply power to the XP5 from either of the two inputs** and use the other one to link a second XP5 using a Truetone DCLINK, DC12 or DC18 cable.

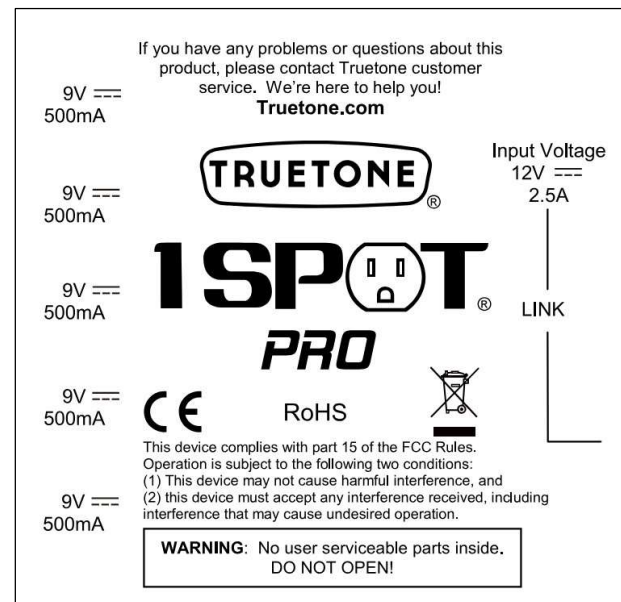

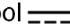
Note: This symbol  indicates DC voltage.



Pro Tip: Photo showing an XP5 being used as a pedal riser on a pedalboard.

## Notes on certain pedals:

- The vast majority of pedals use 9Vdc. Check your pedals to make sure they require 9Vdc, as that is the voltage on all outputs of the XP5.
- Eventide Factor pedals and H9/H90 may be powered with the addition of the CL6 converter (sold separately) for proper DC jack tip size and polarity.
- Line 6 M9 will also require the CL6 converter plug (sold separately).
- Line 6 M5 may be powered without a converter plug.
- Line 6 HX series and POD Go require a C2.5 converter (sold separately). Please note, although these pedals can be powered by a single output, we recommend using 2 outputs combined using a Truetone MC2 cable (sold separately) to split the current load.
- If additional analog 9Vdc pedals need to be powered, a Truetone Multi-Plug cable (sold separately) may be connected to any of the 9Vdc outputs depending on mA draw. If additional pedals need isolation, you may purchase another Truetone XP5 or XP8 expansion box which connects to the second input of the XP5. The XP5 has 5 isolated and filtered outputs, while the XP8 has 8.
- Pedals that do not have a power jack, yet are powered normally by a 9Vdc battery, may be connected using a CBAT converter (sold separately).
- Digitech Whammy: Version 5 or Whammy DT may be powered without a converter plug. Versions 1-4 cannot be powered by an XP5.
- Radial Tonebone 15Vdc pedals can only be powered by using a Truetone Voltage Doubler cable (model TVD – sold separately), and using a Reverse Polarity Converter (model CYR – sold separately).

Note: Trademark names mentioned above are for reference only and do not have any affiliation with Truetone.

## Warranty:

The 1 SPOT Pro XP5 and XP5-PS carries a 5-year warranty to the original owner, covering faulty materials and workmanship.

The warranty is considered void for any of the following reasons:

1. The unit has been modified in any way.
2. Any repair has been attempted by anyone other than the manufacturer.

If your unit becomes defective during the warranty period, please contact Truetone to obtain a return authorization. All contact information can be found at [Truetone.com](http://Truetone.com)

**WARNING:** Operation contrary to the guidelines set forth in this manual may damage your pedals. **Truetone is not responsible for the damage of your pedals by improper usage.**

## Input Power Adapter (XP5-PS only):

Your XP5-PS includes a power adapter. Insert the output plug into one of the two (2) input jacks on the back of the XP5. Plug the other end into a wall outlet or power strip.

## Environmental Protection

The trash can symbol indicates that waste electrical products should not be disposed of with household waste. Please recycle where facilities exist. Check with your local authority or retailer for recycling advice.



## FCC Notice:

Note: This equipment has been tested and found to comply with the limits for a Class B digital device, pursuant to part 15 of the FCC Rules. These limits are designed to provide reasonable protection against harmful interference in a residential installation. This equipment generates, uses and can radiate radio frequency energy and, if not installed and used in accordance with the instructions, may cause harmful interference to radio communications. However, there is no guarantee that interference will not occur in a particular installation. If this equipment does cause harmful interference to radio or television reception, which can be determined by turning the equipment off and on, the user is encouraged to try to correct the interference by one or more of the following measures:

- Reorient or relocate the receiving antenna.
- Increase the separation between the equipment and receiver.
- Connect the equipment into an outlet on a circuit different from that to which the receiver is connected.
- Consult the dealer or an experienced radio/TV technician for help.

Changes or modifications not expressly approved by Truetone could void the user's authority to operate the equipment.